

EBS30292

CHECKING THE SWITCHES

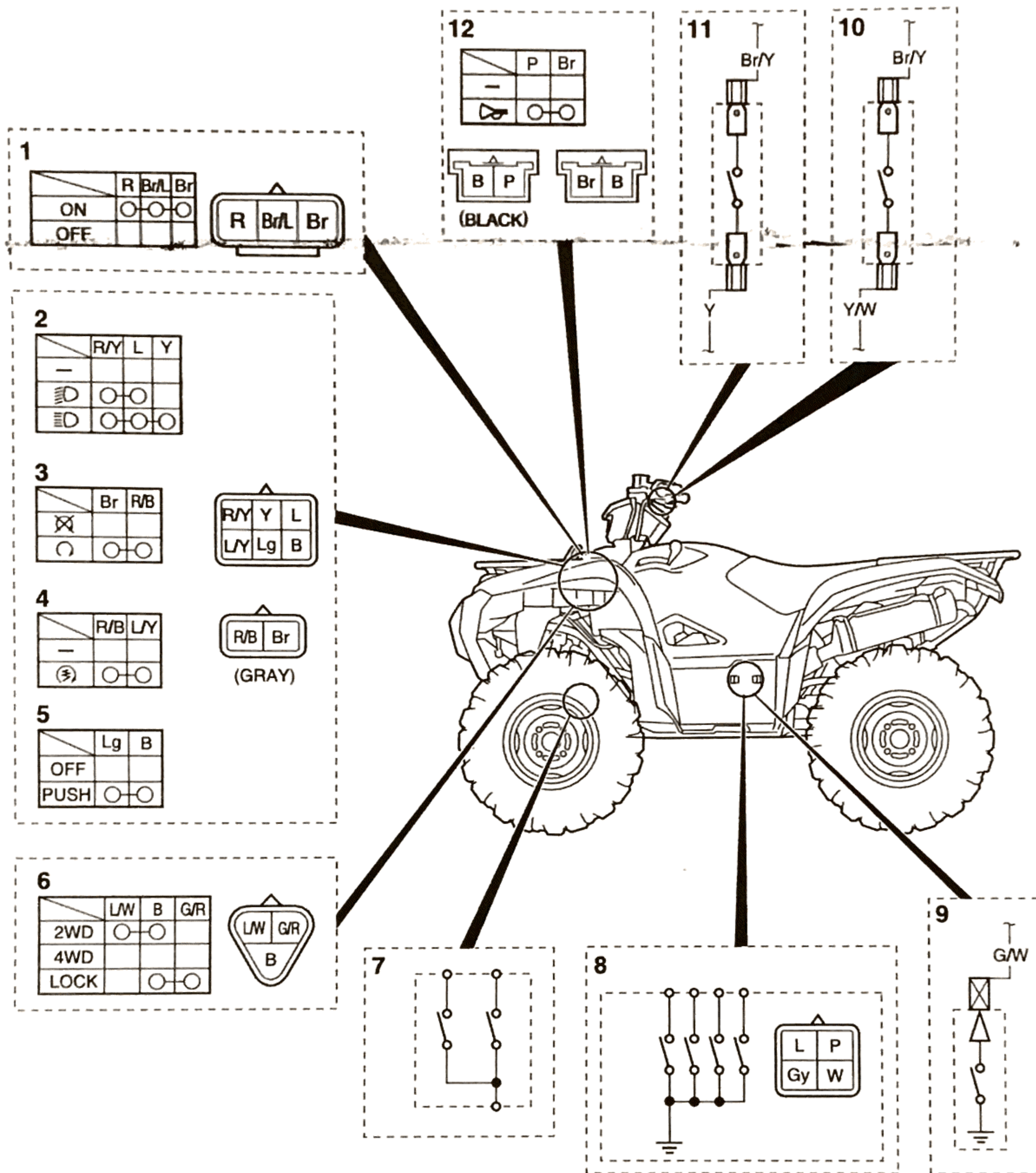

- 1. Main switch
- 2. Light switch
- 3. Engine stop switch
- 4. Start switch
- 5. Override switch
- 6. On-Command four-wheel-drive motor switch and differential gear lock switch
- 7. Four-wheel-drive motor switch (differential motor)

- 8. Gear position switch
- 9. Reverse switch
- 10. Rear brake light switch
- 11. Front brake light switch
- 12. Horn switch (except for CDN)